

The QL 102E is an RS232 interface module. It operates on 12V DC which it takes from the QL NET bus and converts RS232 commands into QL NET commands to control Qlite systems. This module is used to control Qlite system via any 3rd party system capable of giving RS232 hexadecimal commands. The metal construction has been designed and built for safety, reliability and serviceability with top and bottom keyhole fixing. It can be used in both standalone as well as a centralized system.

Specifications

Power Supply

12V DC

Power Requirement

100mA

Protocol

QL NET, RS232

Connectors

QL NET : Detachable 4 pin 3.5mm connector, 2 nos. RJ11 sockets

RS232 : Female DB9 connector

LED Indicators

1 Green LED to show status of power

Power Input

From QL NET bus, additional port for connecting adaptor

Safety Regulatory Compliance

CE



- *RS232 – QL NET convertor*
- *Accepts hexadecimal commands*
- *Allows control of Qlite system via 3rd party systems*

Environment

Ambient Temperature : 0°C to 50°C

Relative Humidity : less than 80%

Dimensions

130mm (W) x 75mm (H) x 35mm (D)

Weight

220g

QL-102E

RS232 INTERFACE MODULE

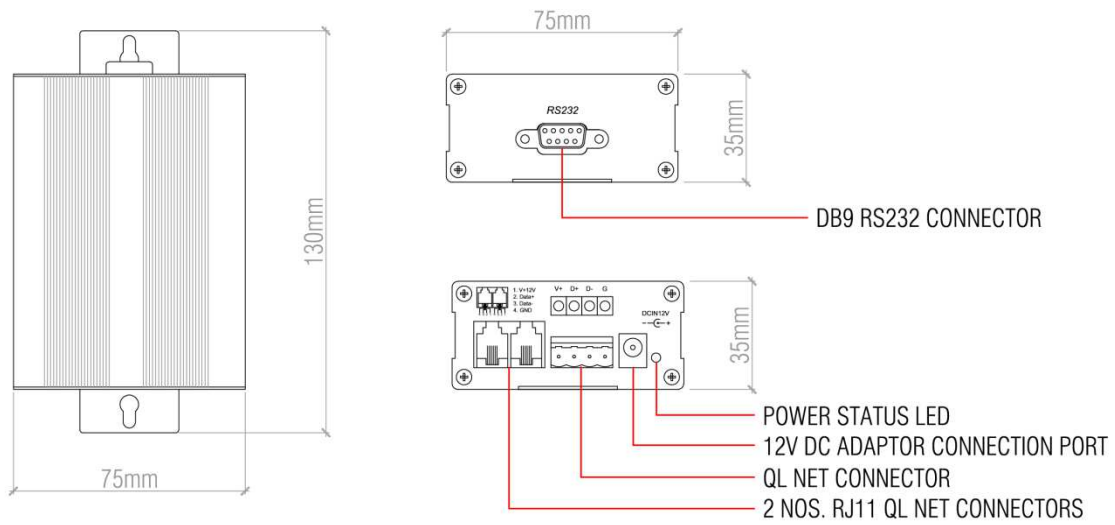

Fig 1. Module Details

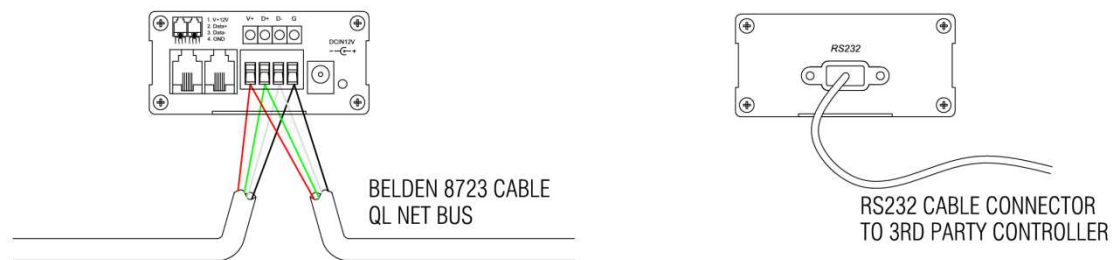

Fig 2. Module Connection

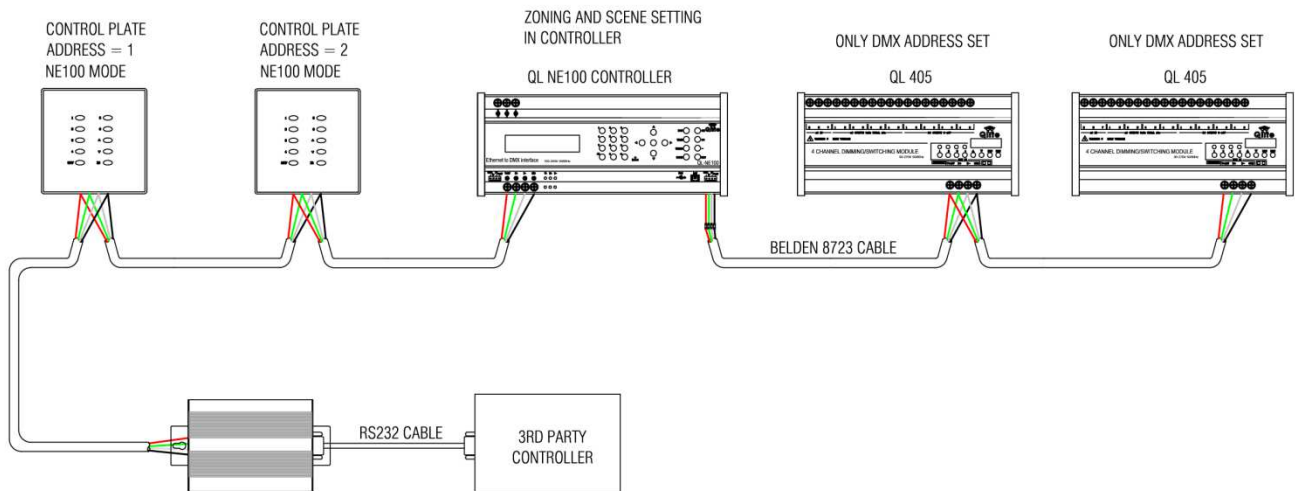

Fig 3. Module Typical Connection – Centralized System