

The QL-LD1 is a standard RFID mortised lock with LCD display. The display can be used to show the room number, status of batteries, time and date, welcome, wrong card etc messages.

In hospitality applications where the aesthetics of the property is top priority, there is a need for the used hardware to blend into the design so seamlessly that it becomes virtually invisible to the user. This model not only does that but combines the latest technology of contactless Radio Frequency Identification (RFID) electronic lock along with its trendy look to give a more secure environment. The sleek and trendy lock series allows designer to choose from a wide range to maintain the essence of their design intact.

The lock is not only easy for the guest to operate; it is as simple for the operator to maintain. The lock series gives the operator complete control over the access to areas and flexibility of allowing, blocking, overriding of any card. It also allows the operator to offer a single access card to the guest for different areas.



- *Easy operation*
- *Wireless stand alone lock*
- *Realizes 95% of online lock system functions*
- *Low battery voltage warning*
- *Self error detecting and indication by beep and LED*
- *Improper lock warning*
- *Dead bolt on the inside*
- *Opening from inside handle retracts latches as well as deadbolt*
- *Individual or Master cylinder option available*
- *Override computer key can be generated for emergency use*
- *Receptionist card issuing records printable*

RFID LOCK WITH DISPLAY

Specifications

Power Supply

4 pcs #5 AA Alkaline Batteries
Average 18 Months' duration

Power Requirement

Stand by load : < 10 μ A
Working load : 100 – 150 mA

Technology

RFID
Compatible with Mifare 1K

Material

Moisture proof and Fire retardant
Stainless Steel with PVD coating
lasting more than 10 years
Panel : SS304
Handle : SS304
Mortise : Cooling Steel
Cylinder : Pure Copper

Mortise Standard

ANSI

LED Status Indicators

Single color LED on reader with dual
beep tone for status

Environment

Ambient Temperature : -50°C to 60°C
Relative Humidity : less than 90%

Safety Regulatory Compliance

CE, FCC

Dimensions

270mm (L) x 74.5mm (W) x 15.5mm
(D)

Weight

2.5 Kg

- Lock operation record printable
- Multiple operators with different card issuing authorizations
- Lost guest card suspension facility
- Definable card validity time
- Classified access authorization for safety management. Ex – general master card, building master card, floor master card etc.
- Flexibility to allow single card to open multiple areas like guest room, parking, swimming pool etc
- Same reader can be integrated for lifts to allow only guests with access card to operate lifts and also restrict non-authorized guests to access certain floors.
- Interface to most PMS systems

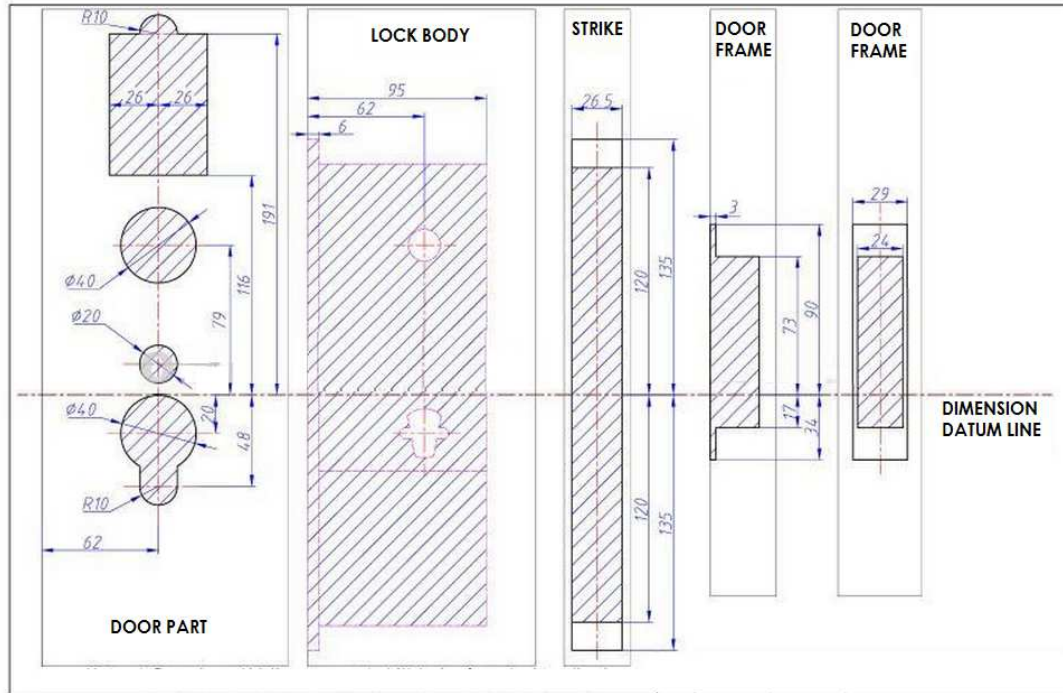

Fig 1. Door Cutting Details



Check-in:
Issue card to guest with relevant info.



Parking:
Access to parking facilities.



Access to elevator:
Access to specified areas only as i.e. elevator.



Other areas:
Guests has access to conference room, gym etc. with keycard.



Enter room:
Access to your room.



Lost keycard:
Hotel issue new keycard, suspend previous card.



Enter room w/new keycard:
New keycard opens the room and invalidates the lost card.



Check-out:
Guest keycard expires automatically or can be manually canceled.

Fig 2. Standard Features