



## Feature:

- ❖ Top bending and top lighting product
- ❖ Lumileds 2835 LED inside
- ❖ Dual- extrusion, diffuse silicone lens and thermal conductive base.
- ❖ UV and yellowish resistant
- ❖ IP67 and salt-mist proof
- ❖ L70B50>50,000hrs
- ❖ UL 94V-0

## QL-AABO2

Dimension: \_\_\_\_\_

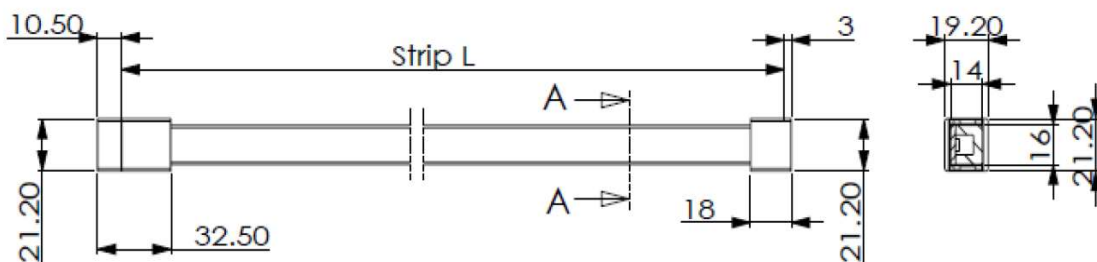

Notes:

1. Unit: mm
2. Strip L = 10meters for 24V products in standard configuration

Application: \_\_\_\_\_

- ❖ Neon tube light source
- ❖ Freezer and cooler lightning
- ❖ Building and sign outline lightning
- ❖ General and cove lightning
- ❖ Ships, boat truck outline lightning
- ❖ Bathroom , spa room lighting

## Electrical parameters: \_\_\_\_\_

Item	QLAAB02
Supply voltage range	24.0±1.0VDC
Supply current range(per meter)	Typ.500mA
Power range( per meter)	10W/M
ESD protection	Contact 4KV, Air 8KV
Max. length for single end power -in	10meters
Max. length for two end power-in	15 meters
Cut unit length	100mm for R/G/B/W/Y products 71.5mm for RGB products

## Optical parameters: \_\_\_\_\_

Part No.	Colorimetric Parameters				Product Flux	LED Type
	Color	Value	CRI	CCT Range	Typ. lm/mtr.	
QL AAB02	White	6500K	Ra. 80	6150-6850K	1000lm	Lumileds 2835
	White	5000K	Ra. 80	4750-5250K	1000lm	Lumileds 2835
	White	4000K	Ra.80	3830-4170K	1000lm	Lumileds 2835
	White	3000K	Ra.80	2850-3150K	850lm	Lumileds 2835
	White	2700K	Ra.80	2600-2800K	680lm	Lumileds 2835
	Red	622.5nm	N.A	N.A	270lm	N.A
	Green	525nm	N.A	N.A	460lm	N.A
	Blue	467.5nm	N.A	N.A	165lm	N.A
	Yellow	590nm	N.A	N.A	240lm	N.A

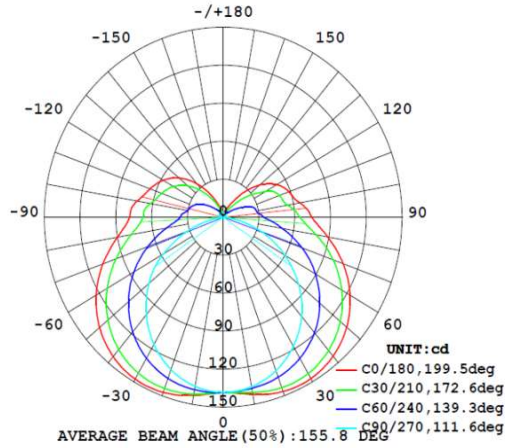

## Connectors

Soldering free power feed and end cap

*IP67 End cap*

*IP67 power feeder*

*Cable from bottom*

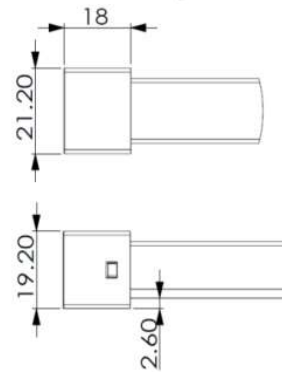
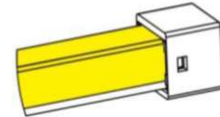
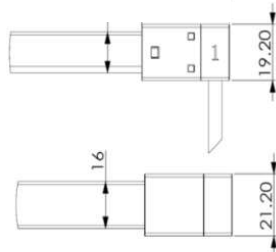
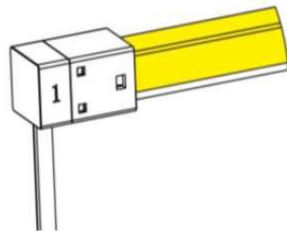

*Side feeder*

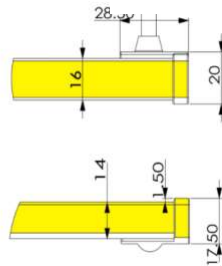
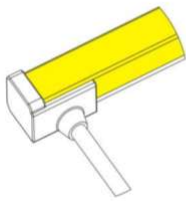

*Bottom feeder*

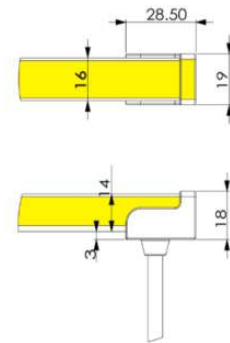
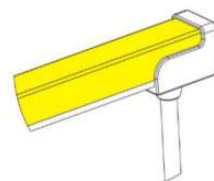

*End feeder*

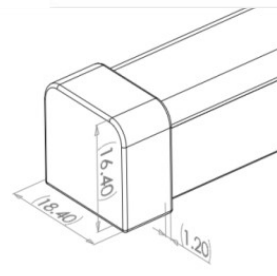
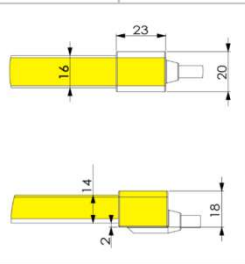
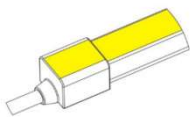

## Wiring:

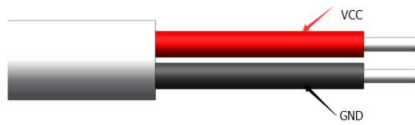

Single color product

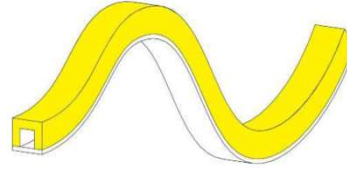

## Installation accessories:

Type 1: transparent PC clips for indoor application

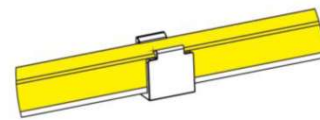
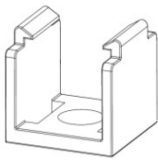

Type 2: Al profile for outdoor application (1meter per pcs ,can be cut to any length)

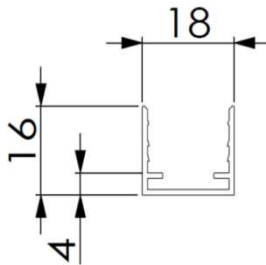

## Attention:

- ❖ The LED neon itself and all its component may not be mechanical stressed
- ❖ Please ensure that the power supply is adequate power to operate the total load .only qualified personnel should be allowed to perform installation
- ❖ The design of the housing should be according to the IP standards in the application
- ❖ If surge protection structure not within power supplier lightning protector should be needed additionally
- ❖ Before cutting and making reconnection ,please read the user manual and please ensure you have read and fully understand it.